

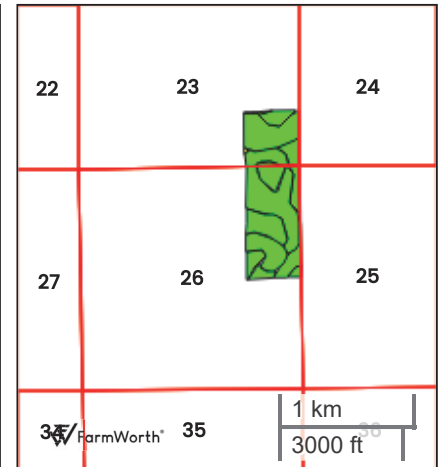

LISTING #18588  
TOTAL SOILS

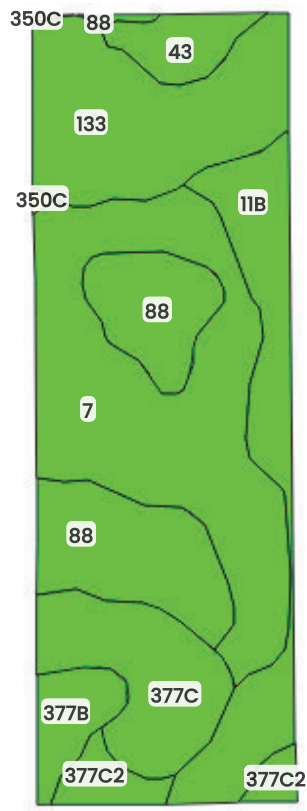

County: **Tama County, IA**  
Location: **26-84N-13W**  
Township: **Oneida**  
Acres: **116.35**  
Date: **09/05/2025**



Field borders obtained from Farm Service Agency  
as of 2008

FarmWorth, LLC makes no representations or warranties, express or implied, as to the accuracy of any information, data, numerical values, boundaries, or any other information generated through the use of FarmWorth.com. User is solely responsible for independently investigating and determining all information provided through FarmWorth.com prior to use and waives any and all claims against FarmWorth, LLC for any inaccuracies or inconsistencies in the information and/or data.

Code		Description	Acres	% of field	IA CSR2	Soil Class (Non-Irr)
7		Wiota silt loam, 0 to 2 percent slopes, rarely flooded	35.60	30.59 %	100	1
133		Colo silty clay loam, 0 to 2 percent slopes, occasionally flooded	20.09	17.27 %	78	2
88		Nevin silty clay loam, 0 to 2 percent slopes	19.83	17.04 %	95	1
11B		Colo-Ely complex, 0 to 5 percent slopes	15.73	13.52 %	86	2
377C		Dinsdale silty clay loam, 5 to 9 percent slopes	12.46	10.71 %	90	3
377B		Dinsdale silty clay loam, 2 to 5 percent slopes	4.27	3.67 %	94	2
43		Bremer silty clay loam, 0 to 2 percent slopes, occasionally flooded	4.18	3.59 %	74	2
377C2		Dinsdale silty clay loam, 5 to 9 percent slopes, eroded	3.95	3.39 %	85	3
350C		Waukegan silt loam, 5 to 9 percent slopes	0.25	0.21 %	50	3
Average:					90.6	

IA has updated the CSR values for each county to CSR2.  
Soils data provided by USDA and NRCS.